

MC55 Quick Start Guide

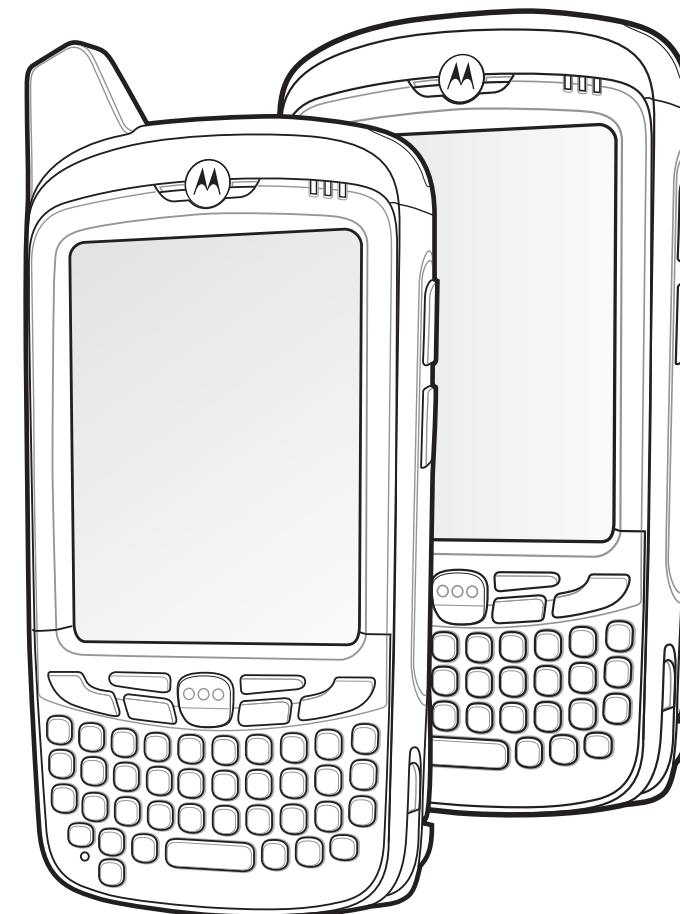

FEATURES

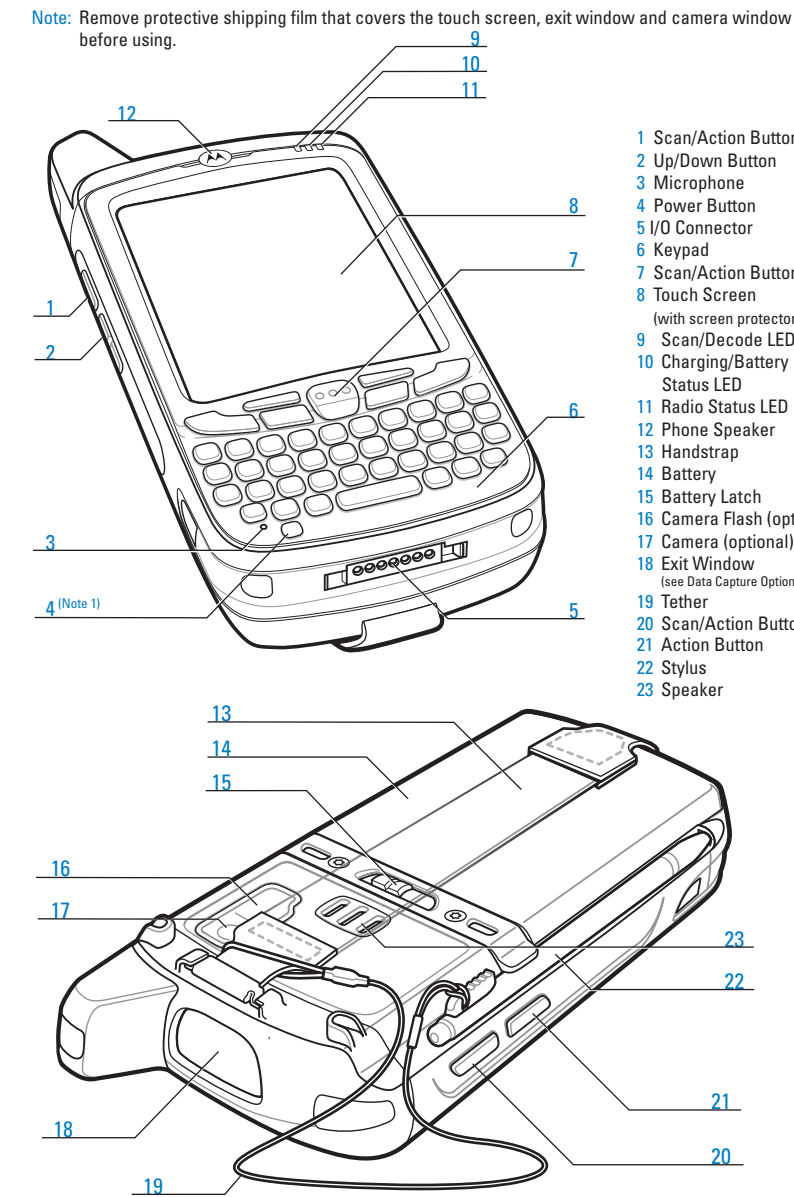

- 1 Scan/Action Button
- 2 Up/Down Button
- 3 Microphone
- 4 Power Button
- 5 I/O Connector
- 6 Keypad
- 7 Scan/Action Button
- 8 Touch Screen (with screen protector)
- 9 Scan/Decode LED
- 10 Charging/Battery Status LED
- 11 Radio Status LED
- 12 Phone Speaker
- 13 Handstrap
- 14 Battery
- 15 Battery Latch
- 16 Camera Flash (optional)
- 17 Camera (optional)
- 18 Exit Window (see Data Capture Options)
- 19 Tether
- 20 Scan/Action Button
- 21 Action Button
- 22 Stylus
- 23 Speaker

Note 1: To reset the MC55, press and hold the Power button for five (5) seconds.

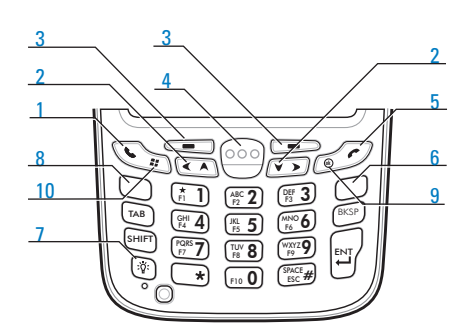

Numeric Keypad

Blue Key

Use this key to access function keys shown on the keypad in blue.
 > Press the Blue key once to activate this state, followed by another key.

Orange Key

Use this key to access the secondary layer of characters.
 > Press the Orange key once to lock the keypad into Alpha state.
 > Press the Orange key a second time to return to the normal state.

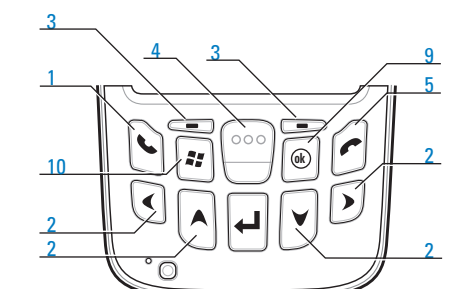

PIM Keypad

Notifications

Scan/Decode LED:

- Red: Scanning active
- Green: Good Decode

Charging/Battery Status LED:

- Slow blinking amber: Battery charging
- Solid amber: Fully charged
- Fast blinking amber: Charging error

Radio Status LED:

- Green: RF active

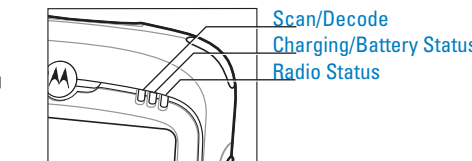

Blue Key

Use this key to access function keys shown on the keypad in blue.
 > Press the Blue key once to activate this state temporarily, followed by another key.
 > Press the Blue key twice to lock this state.
 > Press the Blue key a third time to unlock.

Orange Key

Use this key to access the secondary layer of characters and actions.
 > Press the Orange key once to activate this state temporarily, followed by another key.
 > Press the Orange key twice to lock this state.
 > Press the Orange key a third time to unlock.

- 1 Talk
- 2 Navigation
- 3 Soft Key
- 4 Scan/Action Button
- 5 End
- 6 Orange Key
- 7 Backlight
- 8 Blue Key
- 9 OK
- 10 Start Menu

GETTING STARTED - BATTERY INSTALLATION

Insert the Battery

1. Insert the battery, bottom first, into the battery compartment.
2. Press down on the battery until the battery latch snaps into place.

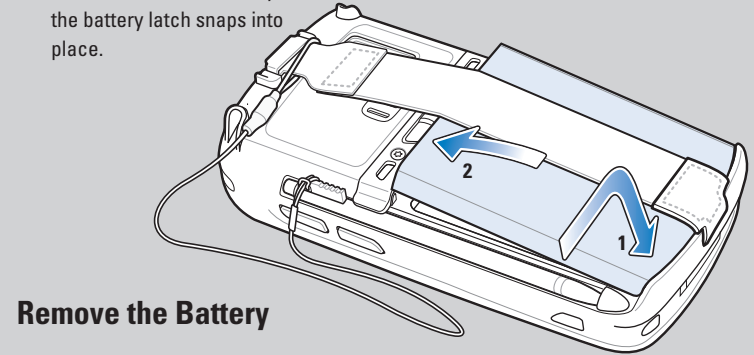

Remove the Battery

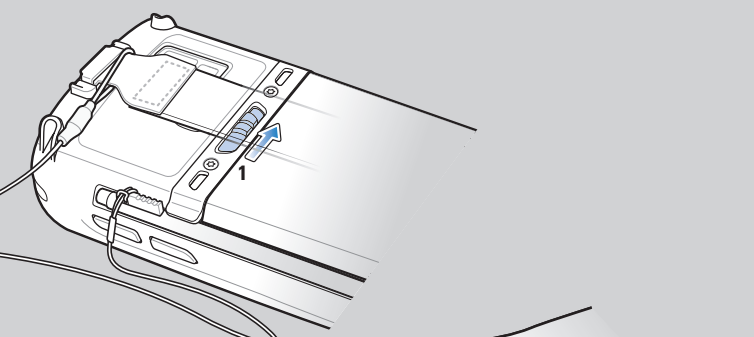

1. Slide battery latch to the right. The battery ejects slightly.
2. Grasp the battery and lift from the MC55.

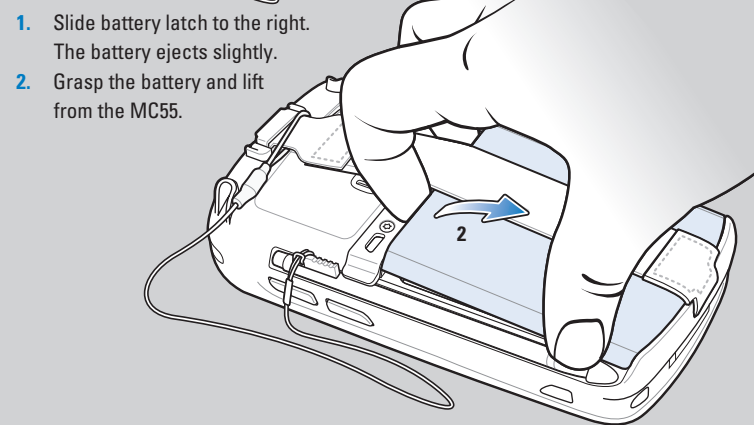

CHARGING

Charge the MC55

Use the Single-slot USB cradle or Four-slot cradles (Charge Only or Ethernet) to charge the battery in the MC55.

You can also charge a spare battery using the Single-slot cradle.

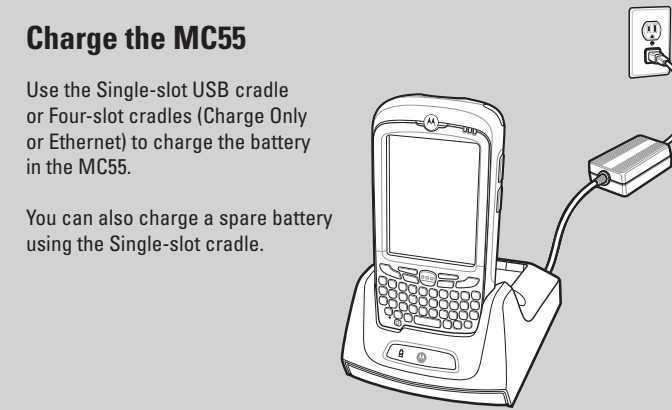

- Charging/Battery Status LED
- Slow Blinking Amber = Charging
- Solid Amber = Fully charged
- Fast Blinking Amber = Charging error

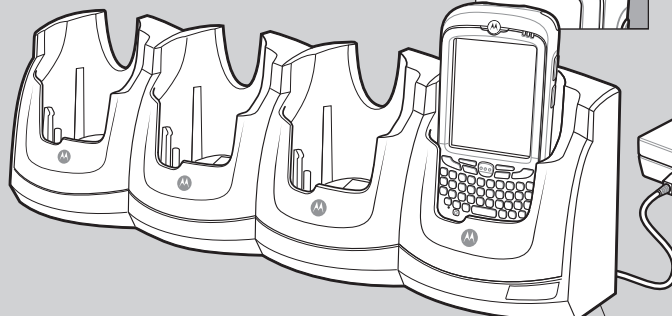

Charge the Battery

Use the Four-slot Battery Charger to charge batteries separately.

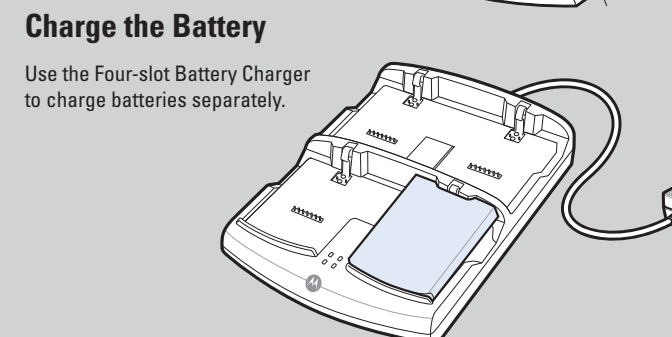

Note: The 2400 mAh battery charges in less than four hours and the 3600 mAh battery charges in less than six hours.

PHONE SETUP

SIM Card Installation

1. Remove battery pack.
2. Lift rubber access door.
3. Slide SIM card holder up to unlock.
4. Lift card holder.
5. Insert SIM card into SIM holder.

NOTE:

The proper position of the SIM card—the card connector (i.e., gold area) should be facing outward with the bevelled corner facing away.

6. Lower the SIM card holder down.
7. Slide SIM card holder down to lock into place.
8. Close rubber access door.
9. Reinstall battery pack.

Enter Your PIN

After installing the SIM card activate your mobile service connection. In most cases, SIM cards are preset with a PIN (Personal Identity Number), provided by your service provider.

1. Press the Power button to turn on the MC55.
2. Tap Start > Phone.
3. Enter the PIN from your service provider.
4. Tap Enter.

Turn On the Phone Function

1. Launch the Wireless Manager application.
 - On the Today screen, tap the Wireless Manager icon.
 - or
 - On the Today screen, tap the signal icon and select Wireless Manager.

Turn Off the Phone Function

1. Launch the Wireless Manager application.
 - On the Today screen, tap the Wireless Manager icon.
 - or
 - On the Today screen, tap the signal icon and select Wireless Manager.

Turn Off the Phone Function

2. On the Wireless Manager screen, tap Phone to turn off phone function.

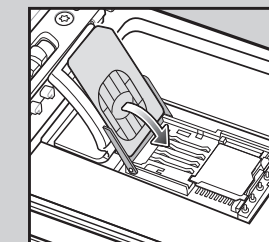
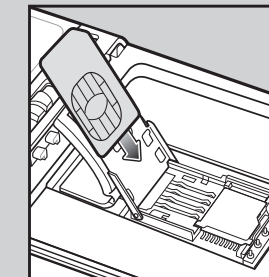
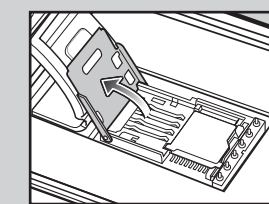

COMMUNICATION

Install ActiveSync®

Download ActiveSync® 4.5 or higher from <http://www.microsoft.com> and follow the instructions to install ActiveSync onto the host computer.

Communicate with Host

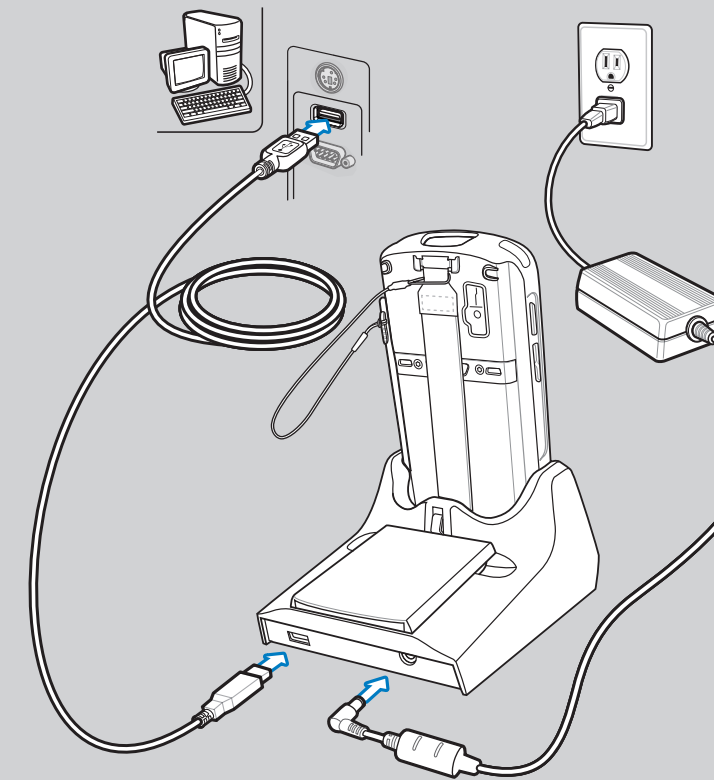

Create a Partnership

Follow the on-screen ActiveSync instructions to establish a connection between the MC55 and the host computer.

More Information on the MC55

Visit the Motorola Web site at <http://www.motorola.com/mc55>

Setting up, using and troubleshooting the MC55

MC55 User Guide and Integrator Guide
Software Upgrades

Available at: <http://www.motorola.com/enterprisemobility/support>

Additional Software

Check Motorola web site for approved applications.
<http://www.motorola.com/mc55>

Connecting and synchronizing with the host computer

ActiveSync® Help on the host computer. To view help, start ActiveSync®, Click Help - Microsoft ActiveSync Help.
ActiveSync software available at <http://www.microsoft.com/windowsmobile>
Information on using programs on the MC55
Tap **Start** – **Help** within the specific program.

Service and Warranty

MC55 Regulatory Guide

Available with MC55 and at <http://www.motorola.com/enterprisemobility/manuals>



MOTOROLA

Motorola, Inc.
One Motorola Plaza Holtsville, New York 11742-1300, USA
MOTOROLA and the Stylized M Logo and Symbol and the Symbol logo are registered in the U.S. Patent and Trademark Office. All other product or service names are the property of their respective owners. © Motorola, Inc. 2009



72-114971-01 Rev. A — January 2009

ACCESSORIES

Screen Protector

Motorola recommends the continued use of a screen protector to minimize wear and tear. Screen protectors enhance the usability and durability of touch screen displays.

Benefits include:

- Protection from scratches and gouges
- Durable writing and touch surface with tactile feel
- Abrasion and chemical resistance
- Glare reduction
- Keeping the device's screen looking like new
- Quick and easy installation.

Not using a screen protector can affect your warranty coverage. An initial screen protector is already applied to your MC55. Contact your local account manager or Motorola, Inc. for more information and purchasing details. Part number: KT-67525-01R Screen Protector 3/pk.

MicroSD Card Installation

1. Remove battery.
2. Lift rubber access door.
3. Slide SIM card holder up to unlock.
4. Lift SIM card holder.
5. Carefully lift microSD card holder.
6. Insert microSD card into card holder.

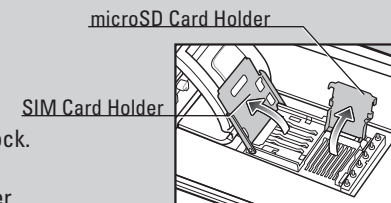

NOTE:

Proper position of the microSD card — the card connector (i.e., gold contacts) should be facing out as shown.

7. Close the microSD card holder.
8. Close the SIM card holder.
9. Slide the SIM card holder down to lock into place.
10. Close rubber access door.
11. Replace battery.

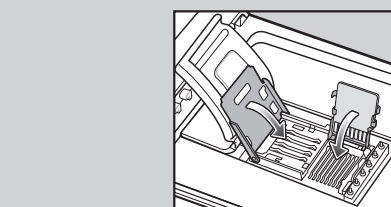
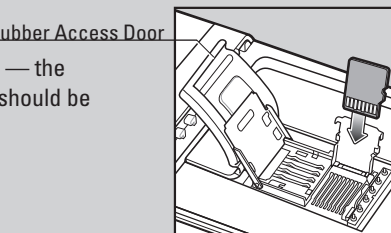

Single-slot USB Cradle

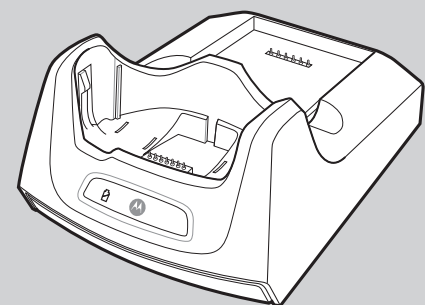

Four-slot Battery Charger

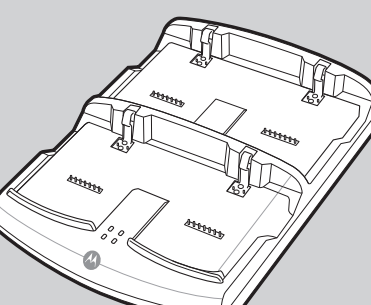

Charge Only Cable

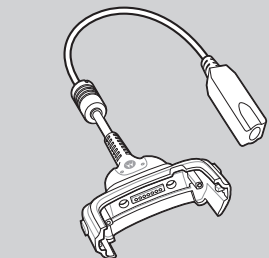

USB/Charge Cable

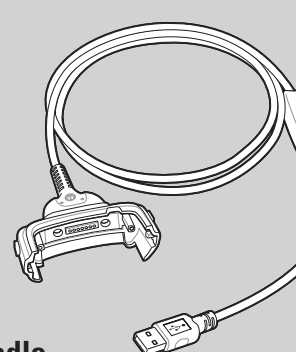

Vehicle Cradle

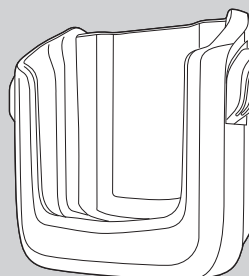

Auto Charge Cable

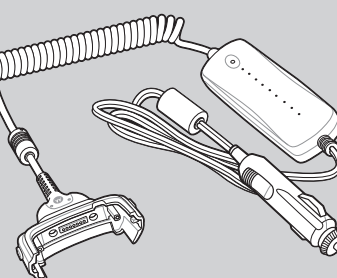

Vehicle Holder

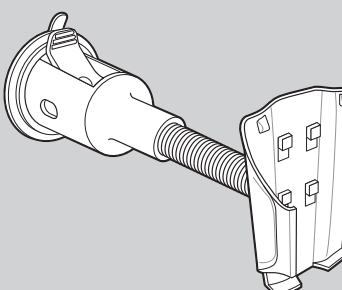

Four-slot Charge Only Cradle Four-slot Ethernet Cradle

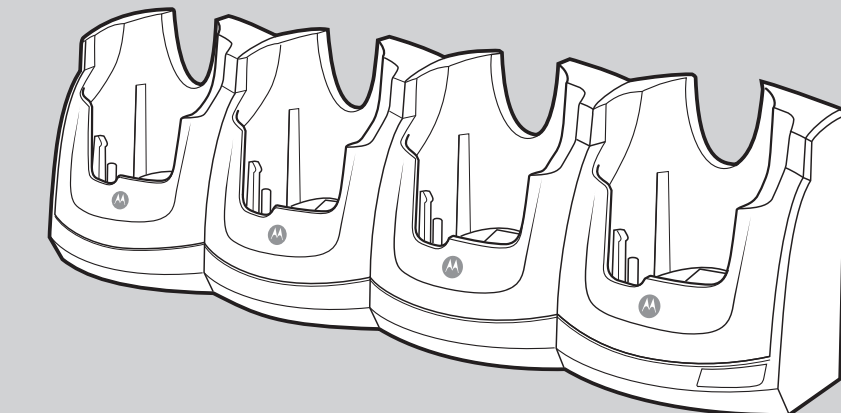

DATA CAPTURE OPTIONS

NOTE: Data Capture Options are dependent upon configurations.

- Laser Scanning only
- Laser Scanning and Camera
- Imaging only
- Imaging and Camera

Laser Scanning

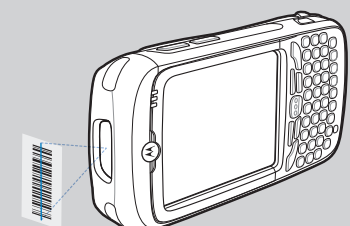
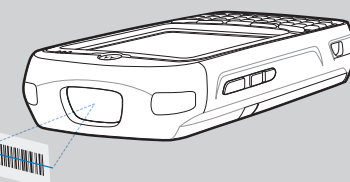

Imaging

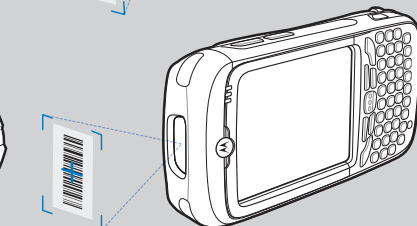
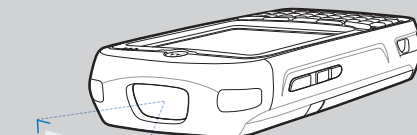

Camera Decode

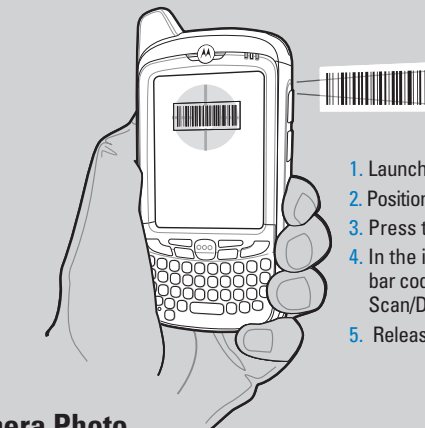

1. Launch a bar code reading application on the MC55.
2. Position the MC55 toward the bar code.
3. Press the **Scan** button.
4. In the image window align the red target over the bar code. When the MC55 decodes the bar code the Scan/Decode LED light green and a beep sounds.
5. Release the **Scan** button.

Camera Photo

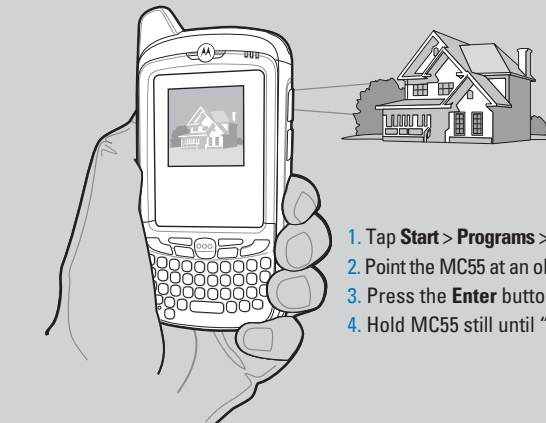

1. Tap **Start** > **Programs** > **Pictures & Videos** > **Camera**.
2. Point the MC55 at an object.
3. Press the **Enter** button.
4. Hold MC55 still until "Shutter Sound" is heard.

GPS Information

When using the GPS feature of the MC5574:

- Acquiring satellite signals may take a few minutes. It is best to be outside and have a clear, unobstructed view of the sky.
- Without a clear view, acquisition takes much longer and could result in the MC5574 being unable to compute the initial position quickly.
- Obtain a satellite fix before moving.
- Shutdown GPS application when not in use.

AVOID EXTREME WRIST ANGLES

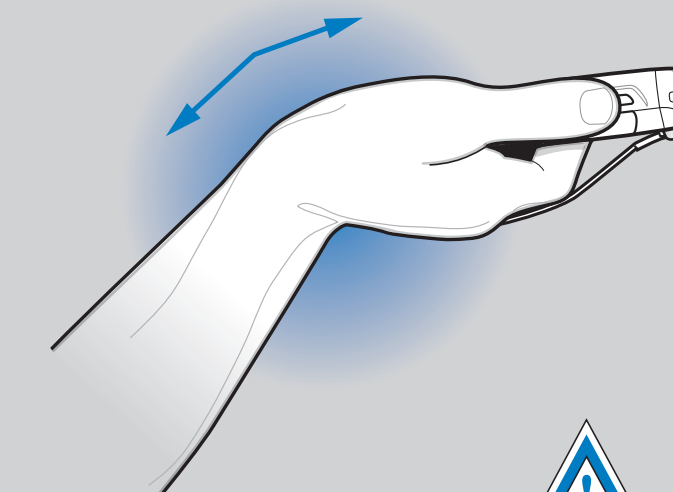

AVOID EXTREME WRIST ANGLES

